



Air release valve
PN 10 of plastic

Explanatory notes on the brochure

General media information in the product descriptions may apply subject to certain restrictions. Kindly always state the relevant medium in your given application when you place an order or submit a query.

If you have any further questions about our products, please do not hesitate to contact our employees of the application engineering division at any time.



Products for use in municipal sewage treatment (www.hawle.de/grenzwerte-abwasser)



For current information, please see our Hawle app. Further information is available at www.hawle.de/en/downloads/hawle-app/hawle-app/

Plastic air release valve

The air release valve made of plastic with its roll-on membrane technology is ideally suited for the intake and release of large air volumes during filling and discharging pipelines as well as for continuous in-service bleeding. The valve seat is not in contact with the medium.

The air release valve operates continuously from 0 to 10 bar and seals perfectly even when unpressurized. No minimum response pressure is required. The sealing principle using a roll-on membrane also has a shock-absorbing property.

The low weight of a PA air release valve ensures easy and quick installation. The clamp ring made of stainless steel also allows the valve body to be opened and closed quickly for maintenance or cleaning. The integrated ball valve is used for flushing or pressure relief.



Air release valve PN 10
made of plastic (Order no. 989-00)

Technical details:

- Body: PA
- Float: PP
- Outlet elbow: PE with dirt filter
- With ball valve for pressure relief

Special functions (on request):

- Air release only or air intake only
- With outlet elbow for connecting the Hawle exhaust air kit set for air release valves
- With air release stop for compressed air flushing
- Also available as an air release valve set for underground installation

Technical data

Medium:	municipal sewage (www.hawle.de/grenzwerte-abwasser)
Operating temperature:	0 - 40 °C
Operating range:	0 - 10 bar
Max. air release capacity:	DN 50: 166 m ³ /h DN 80: 166 m ³ /h female thread 3": 260 m ³ /h
Venting and ventilation cross section:	480 mm ²
Connection:	female thread 3", flange DN 50, flange DN 80, with Storz coupling on request
Body:	PA

Components: Plastic air release valve



No.	Short designation	Material
1	Upper part of body	PA
2	Lower part of body	PA
6	Clamp ring	stainless steel
10	O-ring	NBR
15	Valve unit, complete	Component, see List of parts (page 5)

Thanks to the clamp ring, the valve body can be opened easily for maintenance or cleaning. This means that the complete valve unit can be easily removed and reinserted. Please note: Air release valves contain compressed air. Before starting any maintenance works, always put the air release valve out of operation by closing the shut-off valve installed below it and by depressurizing it using the integrated ball valve!

List of parts: Plastic air release valve

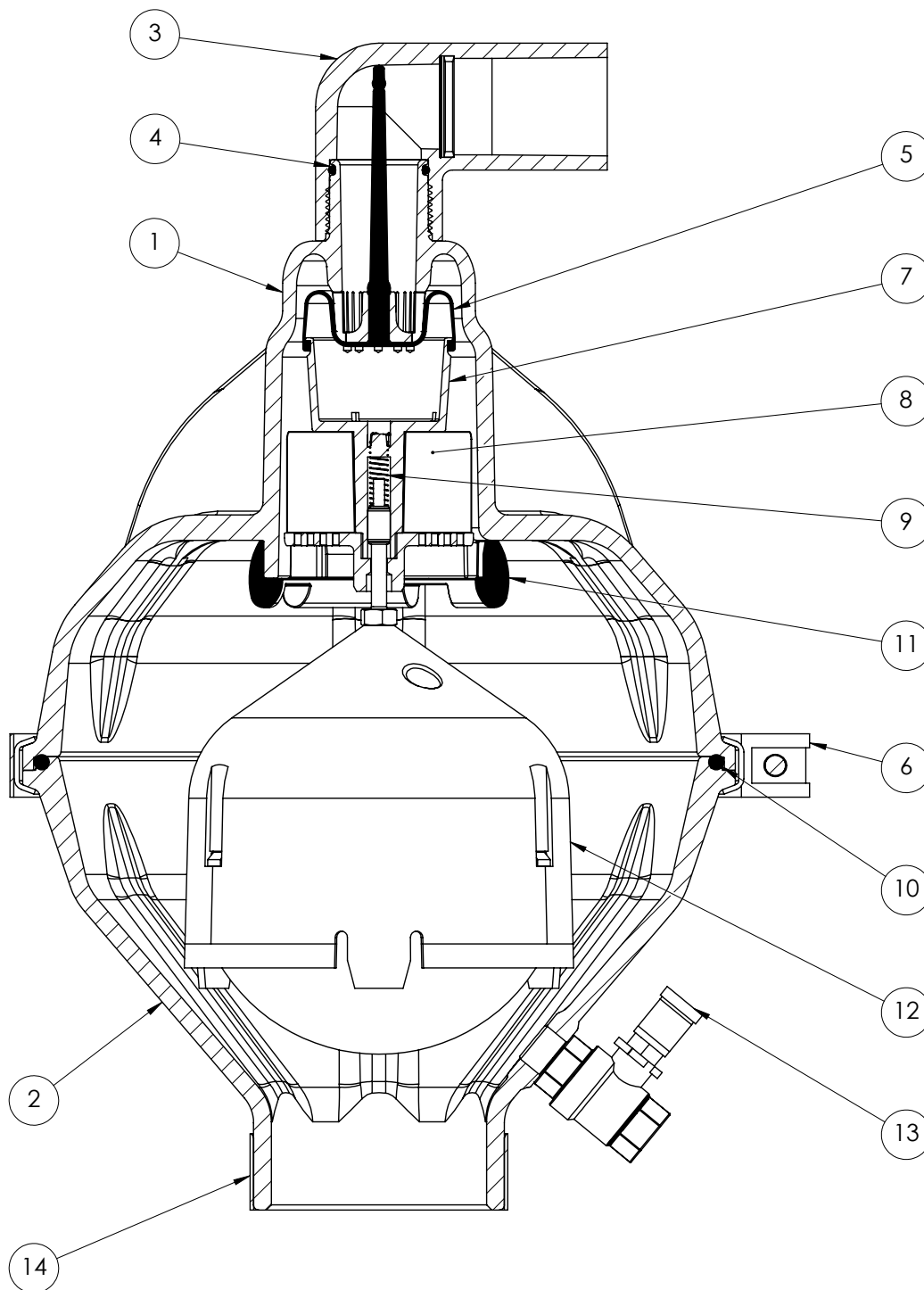

No.	Short designation	Material
1	Upper part of body	PA
2	Lower part of body	PA
3	Outlet elbow with strainer	PE 100
4	O-ring 34x3	NBR
5	Roll-on membrane	HNBR
6	Clamp ring	stainless steel
7	Membrane cup	POM

8	Float rod with membrane cup guide	stainless steel/PP
9	Compression spring	stainless steel
10	O-ring 260x6	NBR
11	Damper ring	EPDM
12	Float	PP
13	Ball valve 3/8"	stainless steel
14	Outer ring	stainless steel

Performance chart / Supplementary products

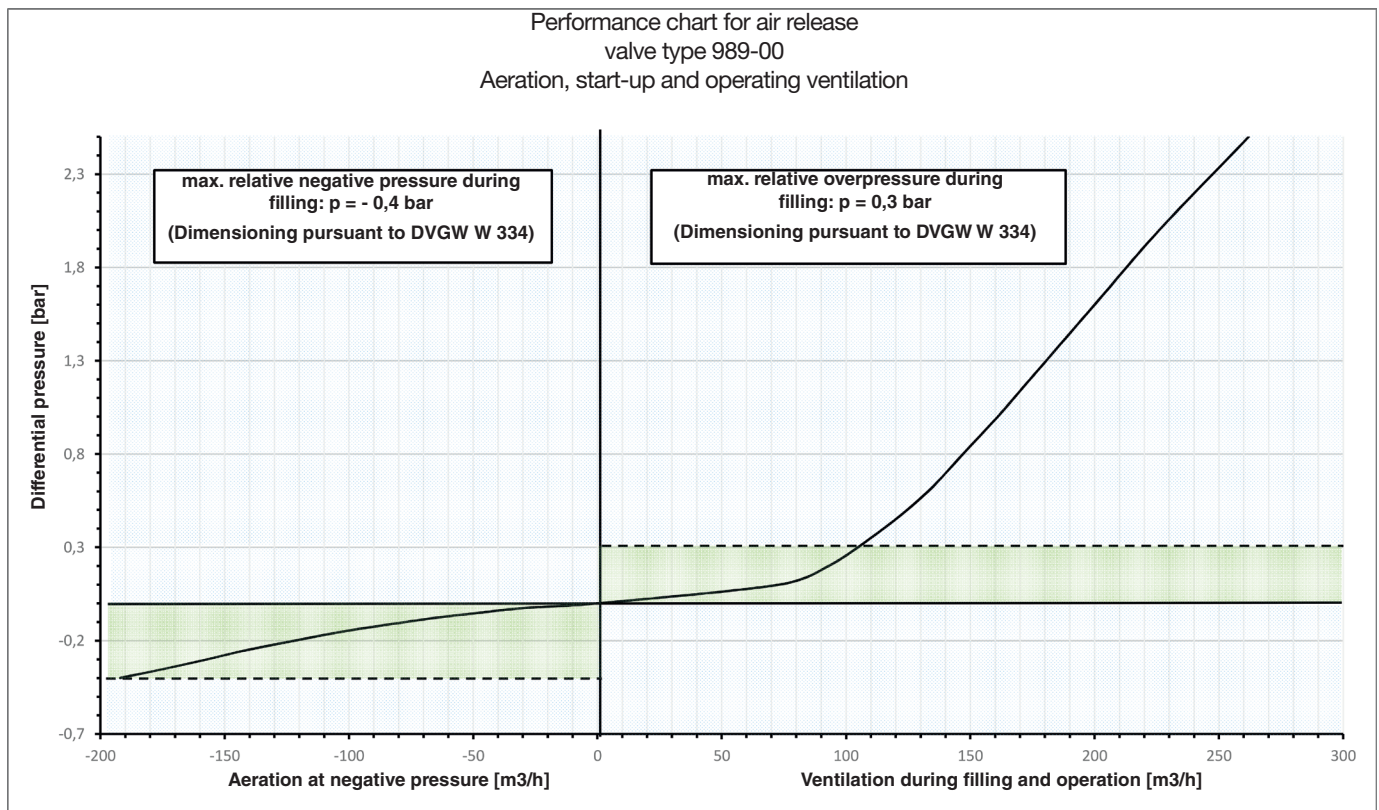

Product supplements

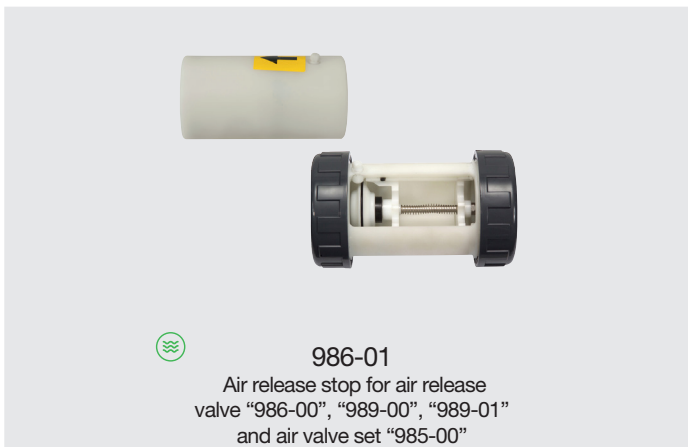

No.:	Description	Material
986-01	Air release stop for air release valve "986-00", "989-00", and air valve set "985-00"	Body and plug: POM Axle / spring / adjusting nut: stainless steel
986-03	Exhaust air set with hose for air release valve	Camlok coupling: PP Hose clip: stainless steel Hose PVC

Hawle Deutschland Armaturen GmbH
Liegnitzer Straße 6
83395 Freilassing
Germany

Tel.: +49 8654 6303-0

info@hawle.de
www.hawle.de/en/



Member of HAIDRO Group

© For further information on our brands, please contact us at info@hawle.de or visit our website on www.hawle.de.
We deliver based on our familiar General Terms and Conditions of Sale (GTC), which are available for downloading.
All illustrations, technical data, dimensions and weights are non-binding. Subject to change. Last updated: 02/2026