



Air Valve of Plastic

About this Brochure

The general media specifications in the product descriptions may possibly be limited. Please make sure to inform us in your order and/or inquiry about the medium for which the respective application is intended.

If you have any more questions on our products, please don't hesitate to contact our employees from Application Engineering any time.



Products for use in the field of municipal waste water (acc. to EN 1085:2007)



In general, all products sold by us are subject to the statutory warranty period of 2 years from the day of delivery by Hawle. Due to the high Hawle product quality, we are able to offer you an extended warranty period of 5 years for all products manufactured by us. For more details, please refer to the Internet: www.hawle.de/warranty

Air Valve of Plastic

The air valve of plastic featuring the unique roll-on membrane technology (Ord. No. 989-00) is perfectly suitable both for taking in and releasing major amounts of air during filling or draining of pipelines and for continuous in-service ventilation. The valve seat is not in contact with the medium.

The air valve operates continuously from 0 to 6 bar, reliably sealing when unpressurized.

The low weight of the air valve of PA allows an easy and quick installation. Moreover, via the profile clamp of stainless steel the valve can be quickly opened and closed in case of maintenance and/or cleaning.



Air valve of plastic
(Ord. No. 989-00)

Technical features:

- Body: PA
- Float: PP
- Outlet elbow: PE with strainer
- With ball valve for pressure relief and sample taking

Special functions on request:

- Air release only or air intake only
- With outlet elbow for connecting a Hawle exhaust air kit for air valves

Technical data

Medium:	sewage water
Max. operating pressure:	6 bar
Test pressure:	12 bar
Max. air release capacity:	260 m ³ /h
Air intake and release cross section:	480 mm ²
Connection:	female thread 3"
Body:	PA

Bill of Material: Air Valve of Plastic

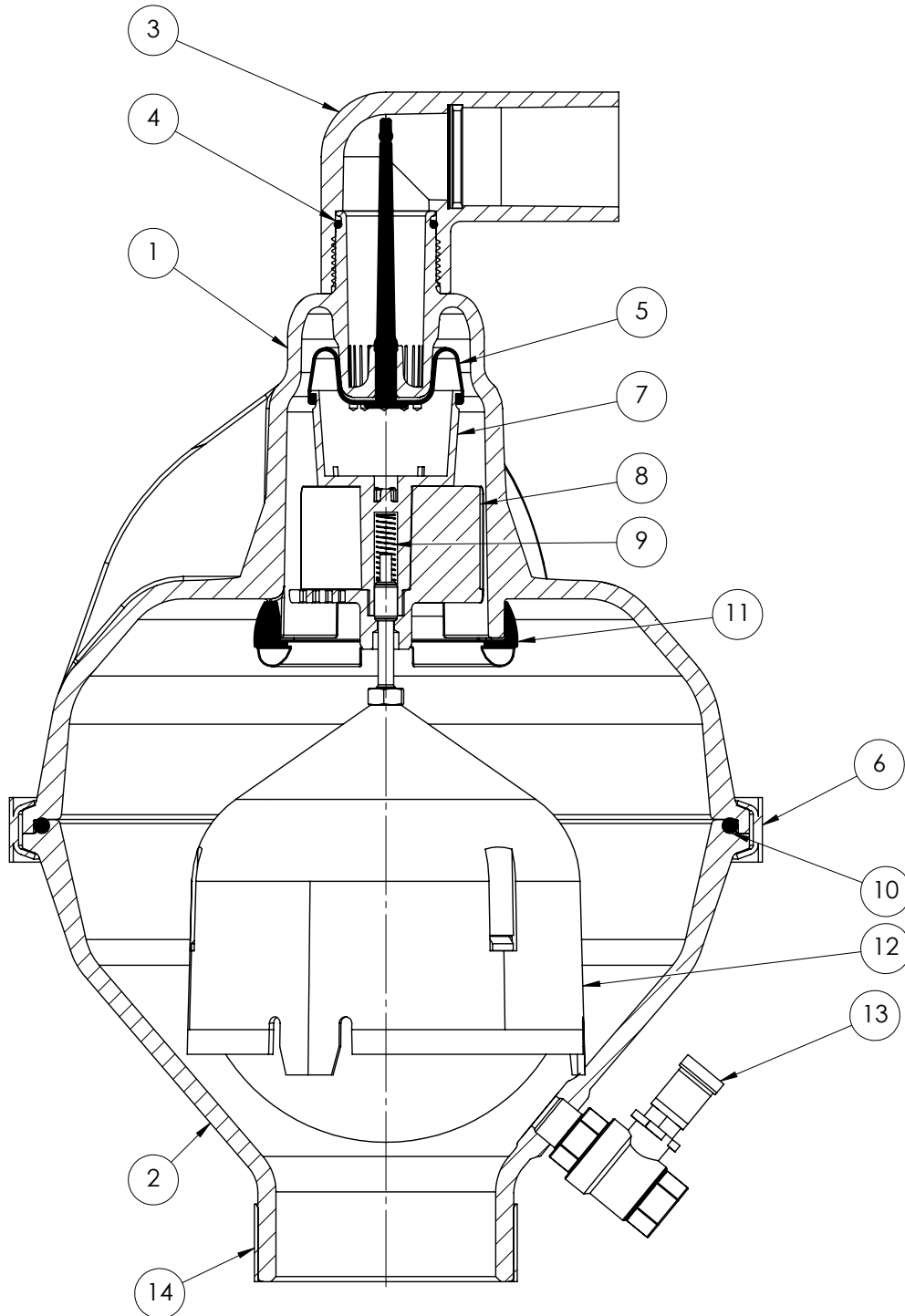

No.	Short description	Material
1	Upper part of body	PA
2	Lower part of body	PA
3	Outlet elbow with strainer	PE
4	O-ring 34x3	NBR
5	Diaphragm	HNBR
6	Profile clamp	Stainless steel
7	Diaphragm cup	POM

8	Float rod with membrane cup guide	Stainless steel/PP
9	Pressure spring	Stainless steel
10	O-ring 260x6	NBR
11	Damper ring	EPDM
12	Float	PP
13	Ball valve 3/8"	Stainless steel
14	Outerring	Stainless steel

Maintenance: Air Valve of Plastic



No.	Short description	Material
1	Upper part of body	PA
2	Lower part of body	PA
6	Profile clamp	Stainless steel
10	O-ring	NBR
15	Complete function unit	Components see bill of material (page 4)

By means of the profile clamp, the valve can be opened easily for maintenance and/or cleaning. Thus, the complete valve unit can be removed and reinstalled easily. Please note: Air valves contain compressed air. Prior to any maintenance work, air valves shall be put out of operation and depressurized via the integral ball valve!

Performance Chart / Supplementary Products

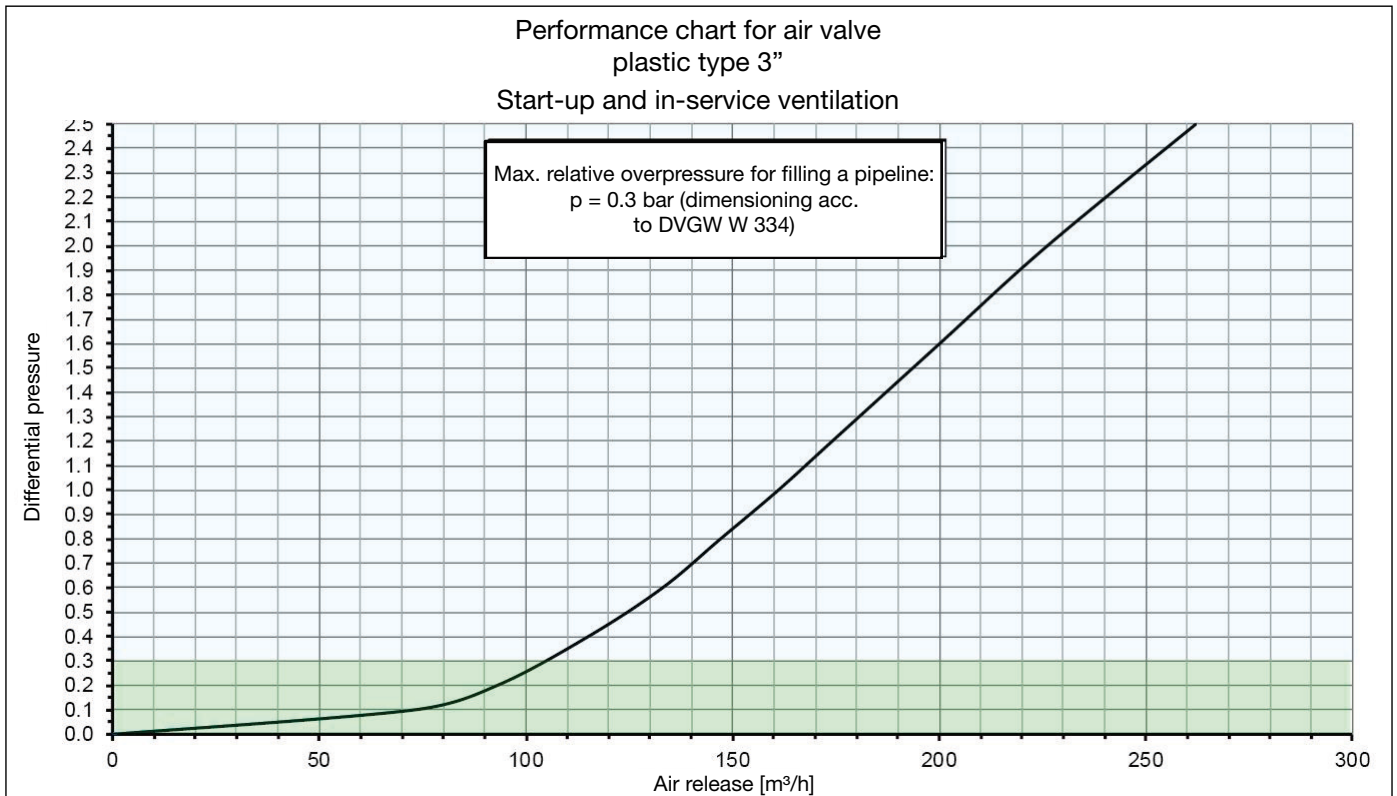

Supplementary Products



Maximum operating pressure

No:	Designation	Maximum operating pressure	Material
372-00	Transition adaptor to thread (being prepared)	10 bar	Stainless steel
986-01	Air release stop for air valve "986-00" and air valve assembly "985-00"	16 bar	Body and sealing cone: POM Shaft / spring / adjusting nut: stainless steel
986-03	Exhaust air kit with hose for air valve	-	Kamlok coupling: PP Hose clip: stainless steel Hose: PVC



Hawle Armaturen GmbH
Liegnitzer Straße 6
83395 Freilassing
Germany

Phone: +49 8654 6303-0
Fax: +49 8654 6303-111

info@hawle.de
www.hawle.de

© For further information about our brands don't hesitate to contact info@hawle.de or our homepage www.hawle.de
We solely supply products in accordance with our General Terms and conditions you can find on our homepage as download.
All pictures and diagrams, technical data, measures and weights are non-binding. Subject to change without notice. EN 04/2019