

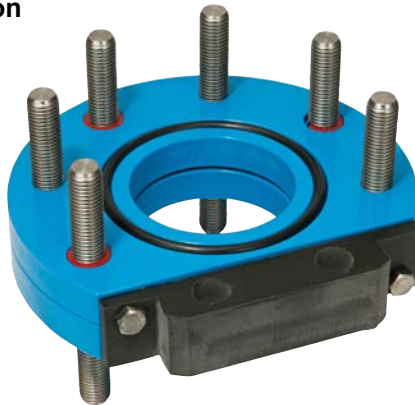

1. Intended use / Product description



Medium: Potable Water, Municipal Sewage

Max. operating pressure: 16 bar

Material:
Body: steel, Hawle epoxy powder coated
Cover: DN 50 steel (Hawle epoxy powder coated), DN 65 - DN 150 POM
Threaded pin: stainless steel
Flange gasket: integral elastomer O-ring gasket

In combination with a shut-off blade/saddle blade, the auxiliary shut-off device via intermediate flange ord. no. 840-00 serves as shut-off element (e.g. below air release valves) between two flanges.

The saddle blade is available as accessory.

In combination with an appropriate drilling device, the shut-off system with integrated auxiliary shut-off device permits an easy under pressure drilling of the main line.

During installation and maintenance operations, the applicable standards and guidelines, accident prevention regulations and the regulations of professional associations are to be observed and complied with. Installation and maintenance operations may be performed by qualified personnel only.

2. Assembly



Assembly auxiliary shut-off device: open-end spanner A/F24 (DN50-100), A/F30 (DN150)
Assembly saddle blade: open-end spanner A/F13, crowbar

Assembly auxiliary shut-off device Ord.No. 373-00

Flange connection:

During the assembly of the auxiliary shut-off device in the pipe, the corresponding DVGW- or DWA-regulations for the establishing of a flange connection are must be observed.

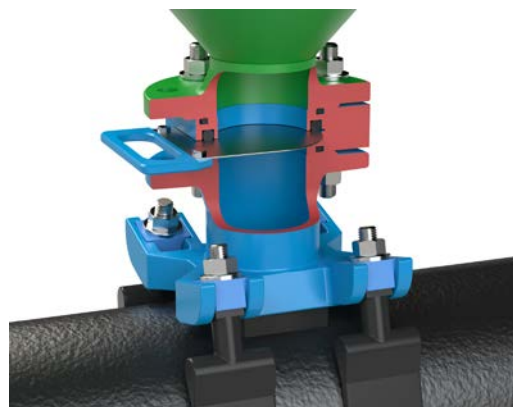

Assembly intermediate flange Ord.No. 840-00

- The installation of the saddle blade should be carried out without pressure (otherwise more force is required).
- Tool for easier installation of the saddle blade:
DN100 Ord.No. 373 980 0100
DN150 Ord.No. 373 980 0150

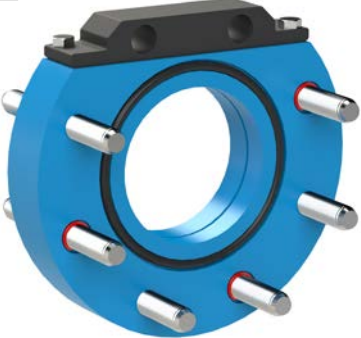
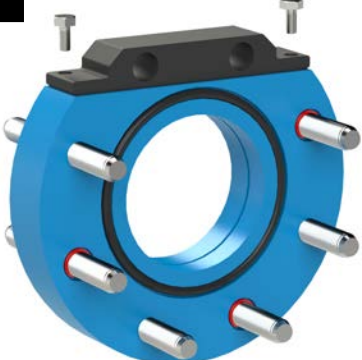
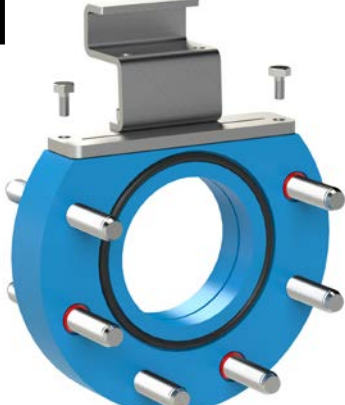
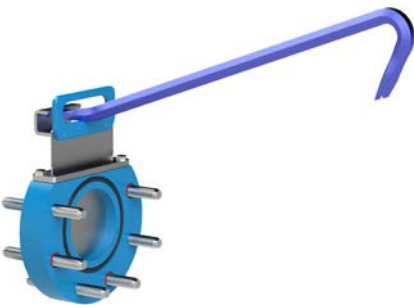
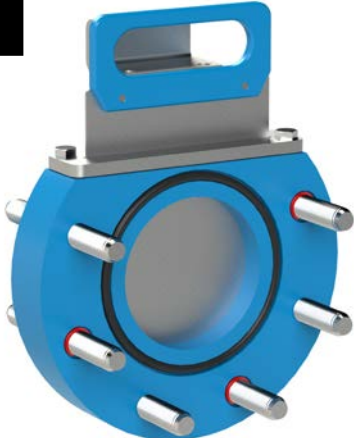
<p>1</p> 	<p>2</p> 	<p>3</p> 
<p>Initial state (delivery with plastic cover)</p>	<p>- Loosen screws - Remove plastic cover</p>	<p>- Place tool - tighten with the screws (removed under no. 2) (approx. 30Nm)</p>
<p>4</p> 	<p>5</p> 	
<p>- Push the saddle blade in as far as possible by hand. - with rod (e.g. crowbar) mount saddle blade</p>	<p>Illustration of the saddle blade in assembled state.</p>	

3. Maintenance

The auxiliary shut-off device is maintenance-free.

4. Commissioning/Pressure test

After successful installation, a pressure test must be carried out in an open pipe trench in accordance with DVGW regulations.

If you have any other questions or if you need more information please contact:

Hawle Armaturen GmbH
- Application Engineering -
Liegnitzer Str. 6
D-83395 Freilassing
Phone: +49 (0)8654 6303-0
E-Mail: info@hawle.de

Telefax: +49 (0)8654 6303-222
Web: www.hawle.de