

1. Intended Use / Product Description:



Material: Square ring: NBR
Slide ring: POM

The brake ring set for the Hawle surface box for service valves and gate valves, Order No. 200-03 and the Hawle surface box for hydrants, Order No. 206-04, allows for simple and infinitely variable height adjustment when installing in bituminous traffic areas. The drawing ring of the surface box does not have to be held in position during the back-filling process, but can be locked at the desired installation height with the aid of the brake ring set.

During installation and maintenance operations, the applicable standards and guidelines, accident prevention regulations and the regulations of professional associations are to be observed and complied with. Installation and maintenance operations should only be carried out by qualified personnel.

2. Installation

1. Position the slide ring (1) on the road cap and install the brake ring (2) on the drawing ring.

Caution: Position the slide ring as accurately as possible and mount the brake ring parallel to the lower edge of the drawing ring. If the two components are not fitted with sufficient accuracy, the drawing ring may become wedged in the surface box.

2. Place the drawing ring together with the brake ring on the surface box and position at the desired height.

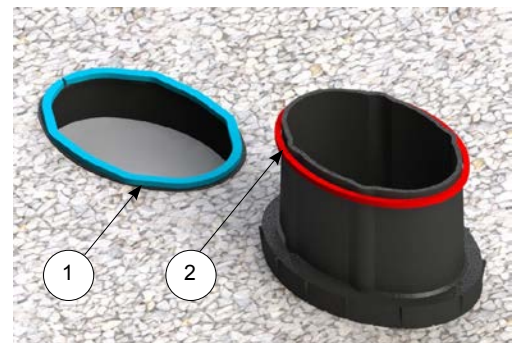

3. See separate operating instructions for installing the surface box. Release the drawing ring, pull it upwards and backfill.

Caution: Despite the brake ring, support the exposed drawing ring to prevent the rubber ring from tearing.

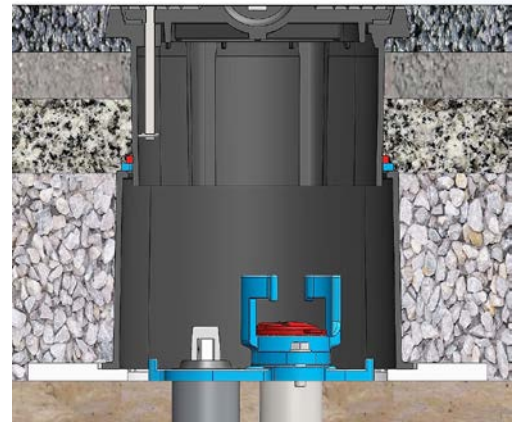

If you have any other questions or if you need more information please contact:

Hawle Armaturen GmbH
- Application Engineering -
Liegnitzer Str. 6
83395 Freilassing
Phone: +49 (0)8654 6303-0
Telefax: +49 (0)8654 6303-222
E-Mail: info@hawle.de
Web: www.hawle.de